

医学部配置図

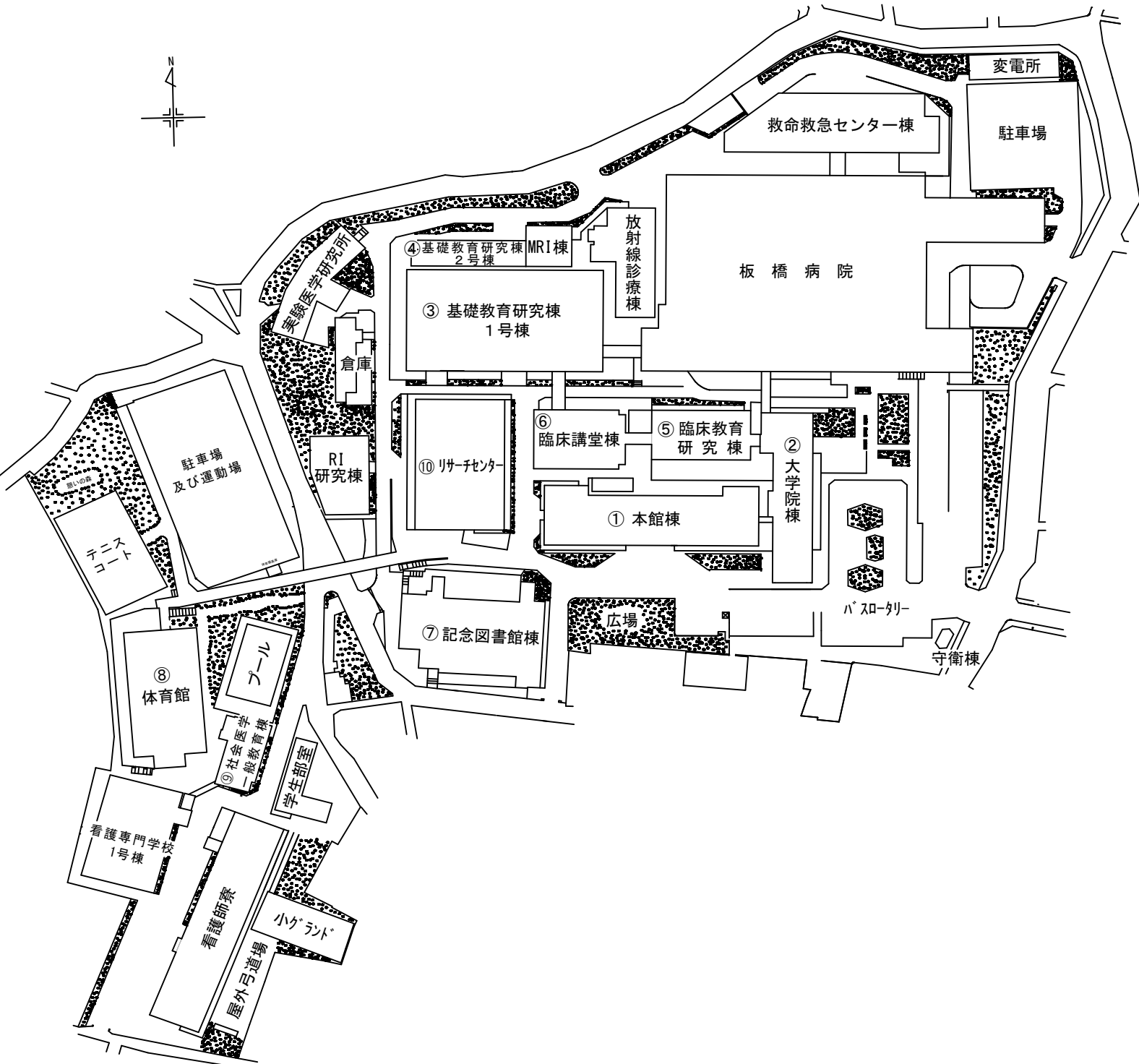

① 本館棟

() 収容人員

4階

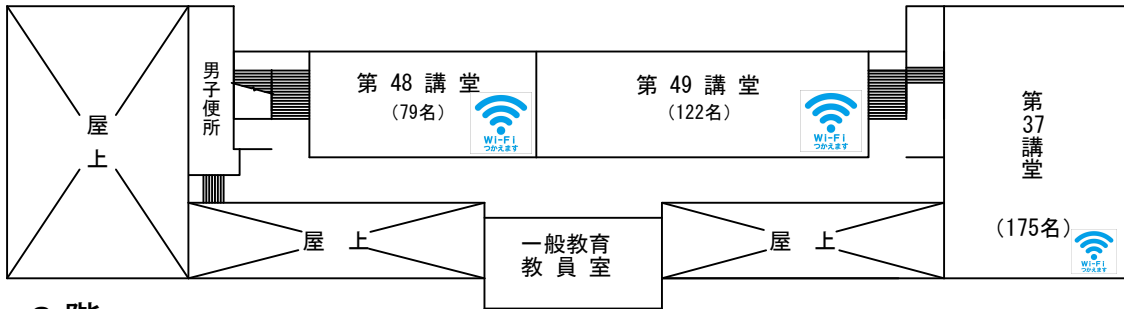

3階

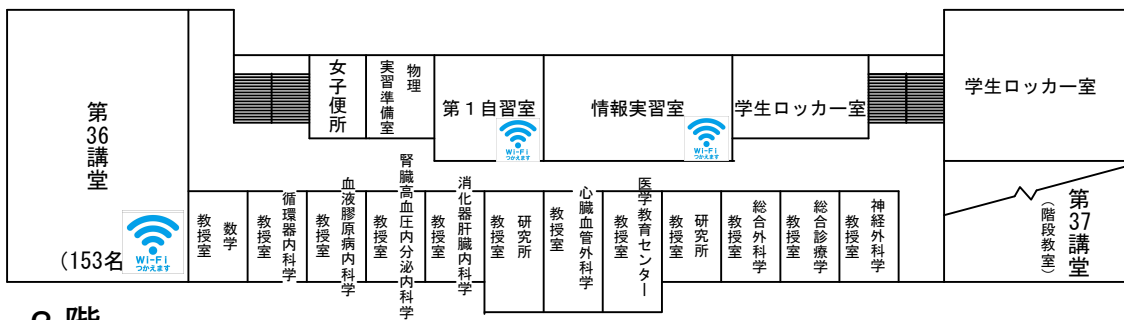

2階

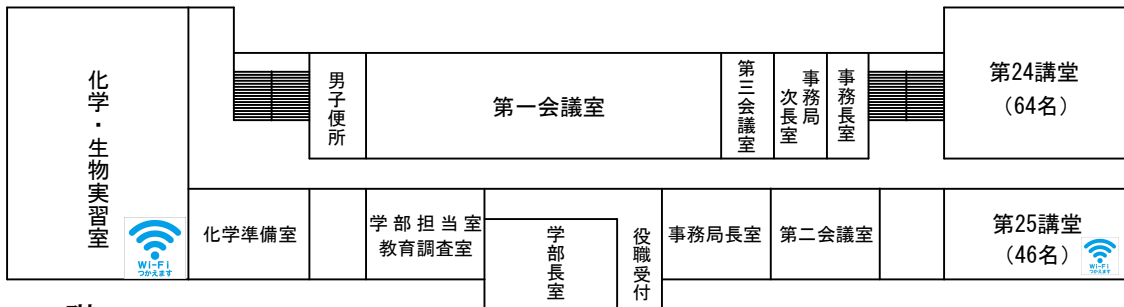

1階

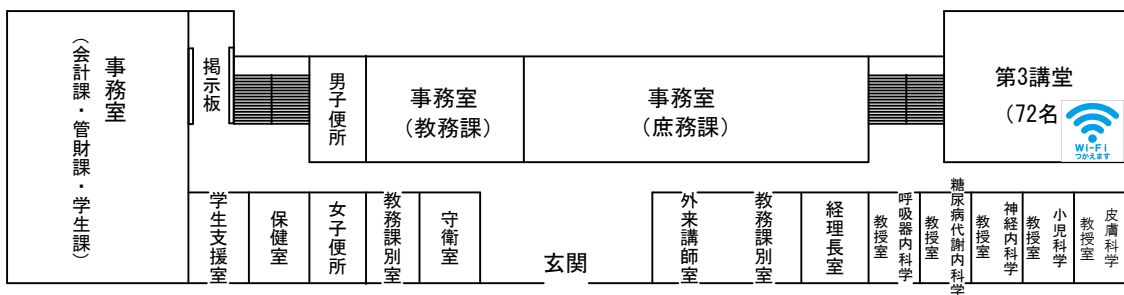

地階

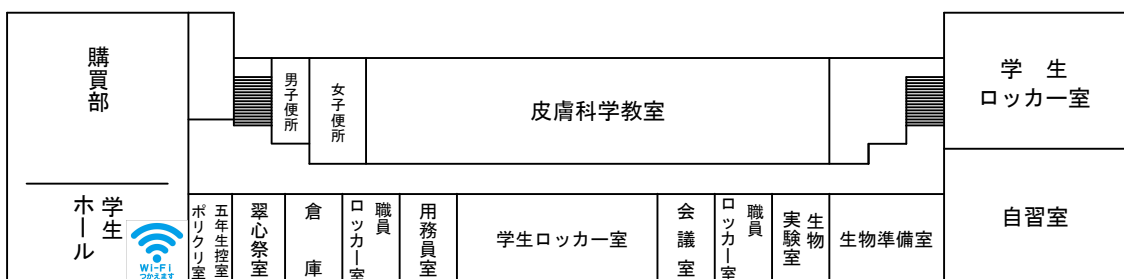

② 大学院棟

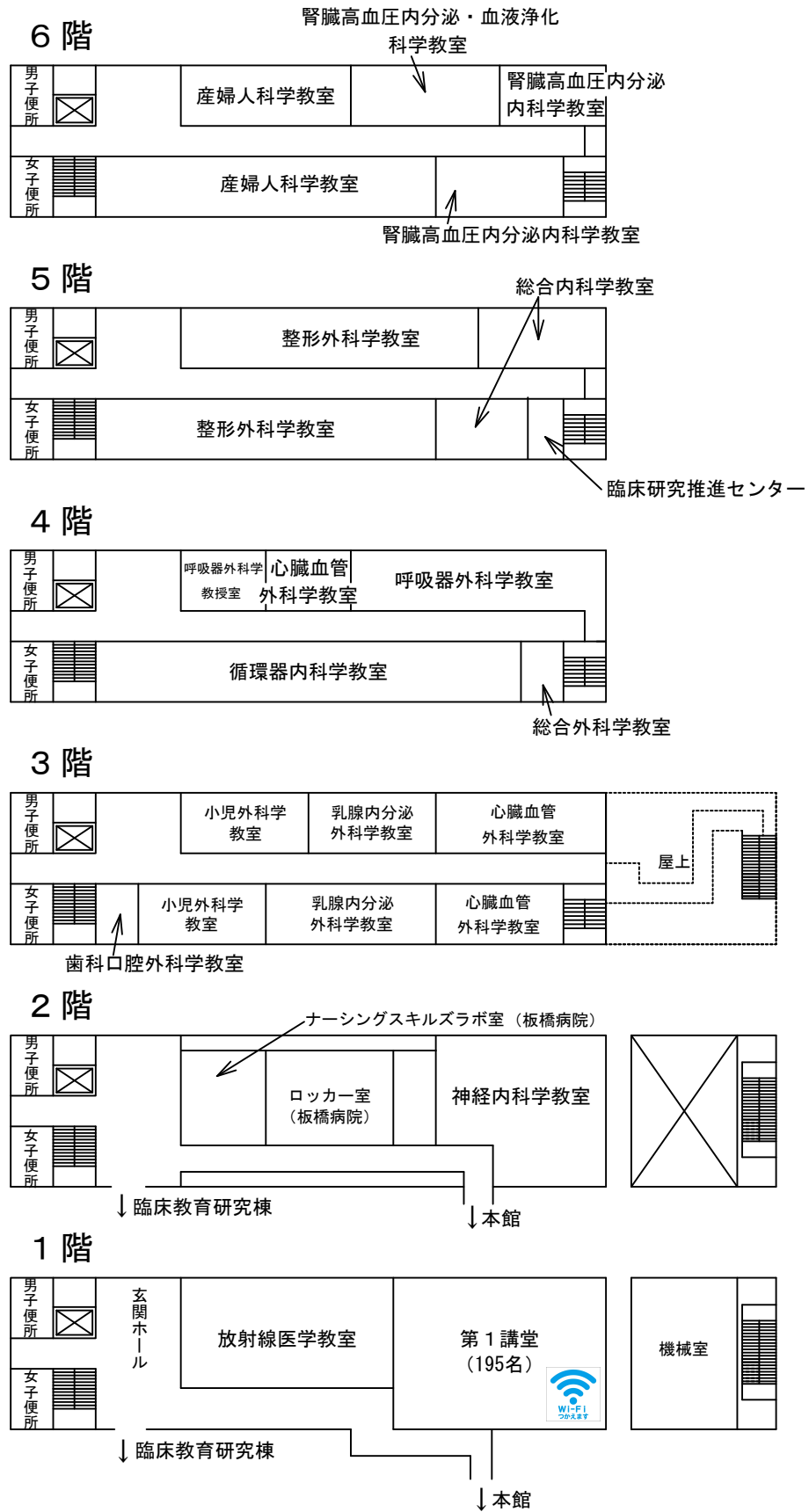

④ 基礎教育研究棟 2号棟

3階

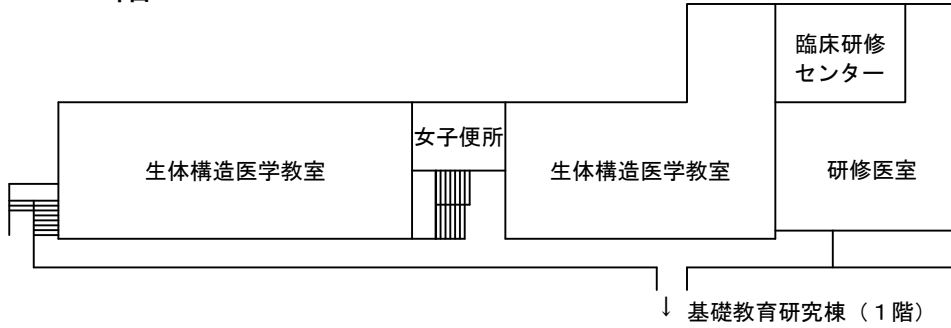

2階

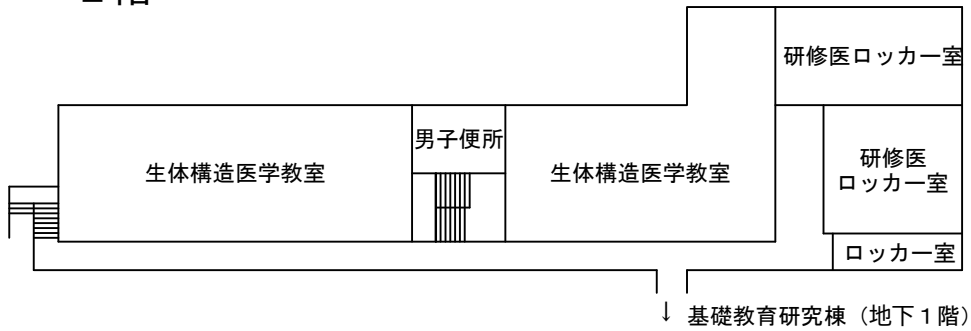

1階

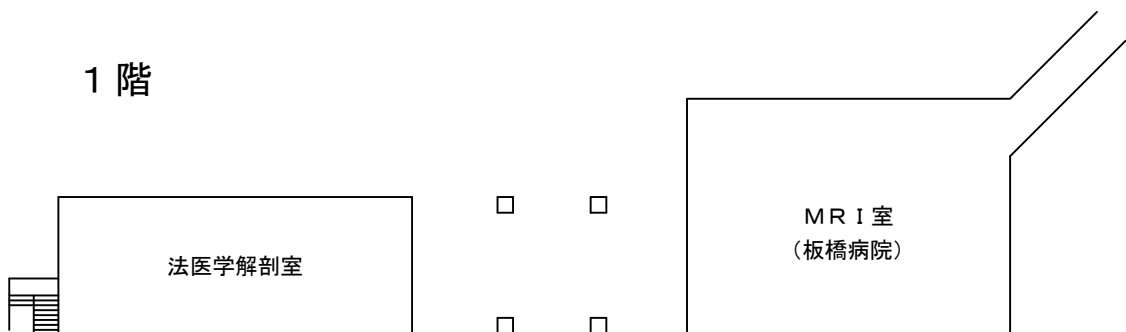

⑤ 臨床教育研究棟

5階

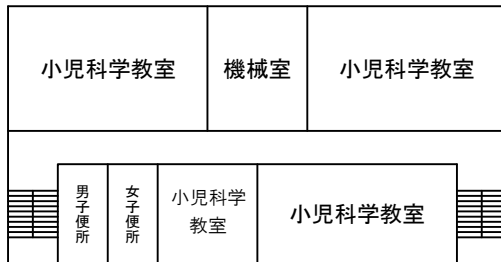

2階

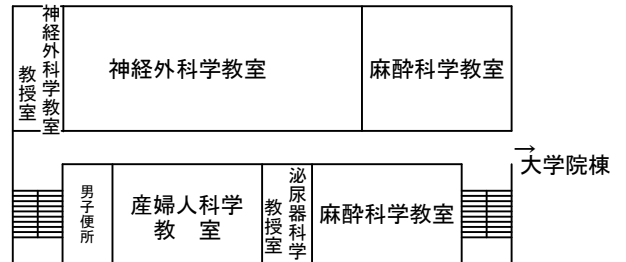

4階

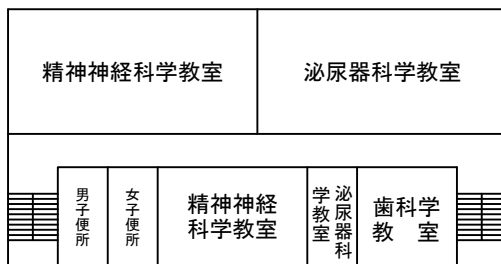

1階

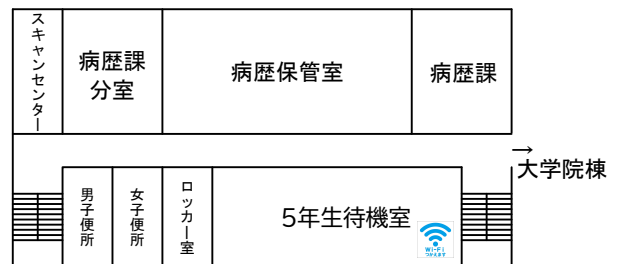

3階

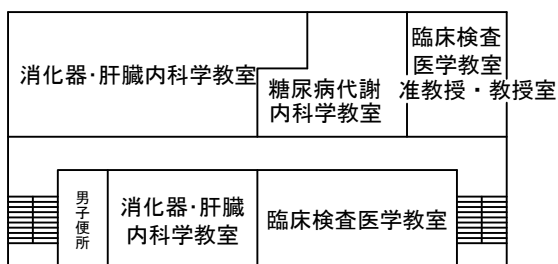

地下1階

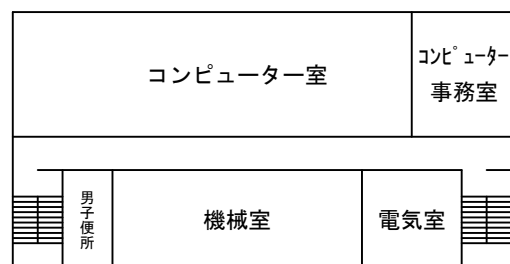

⑥ 臨床講堂棟

() 収容人員

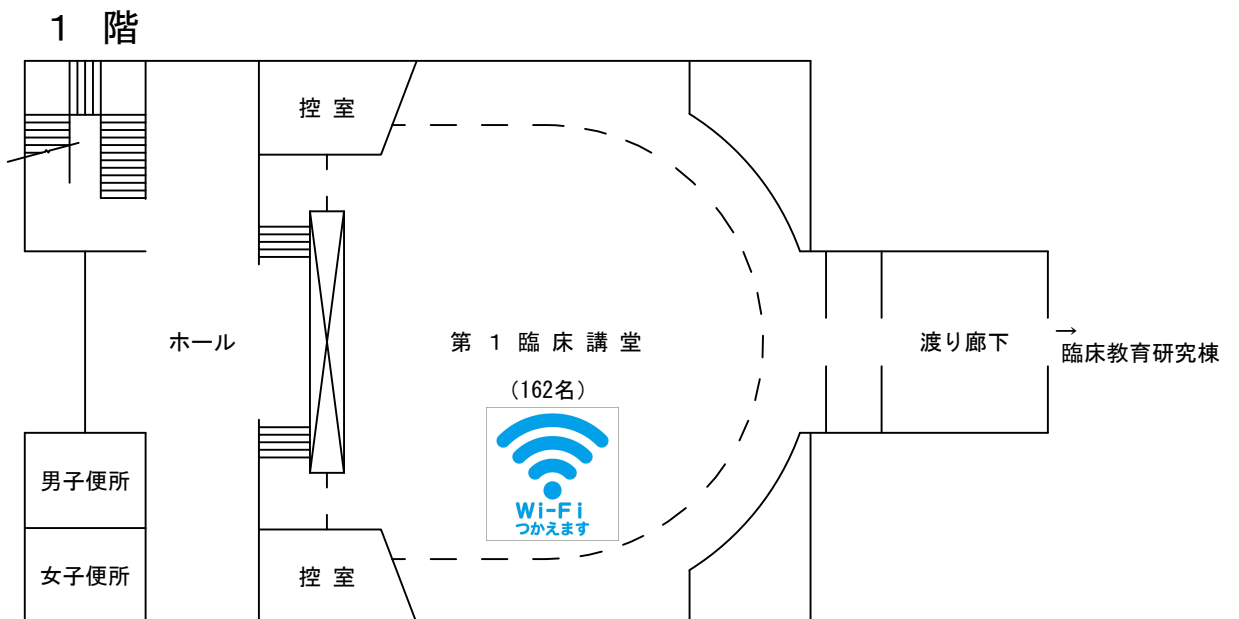
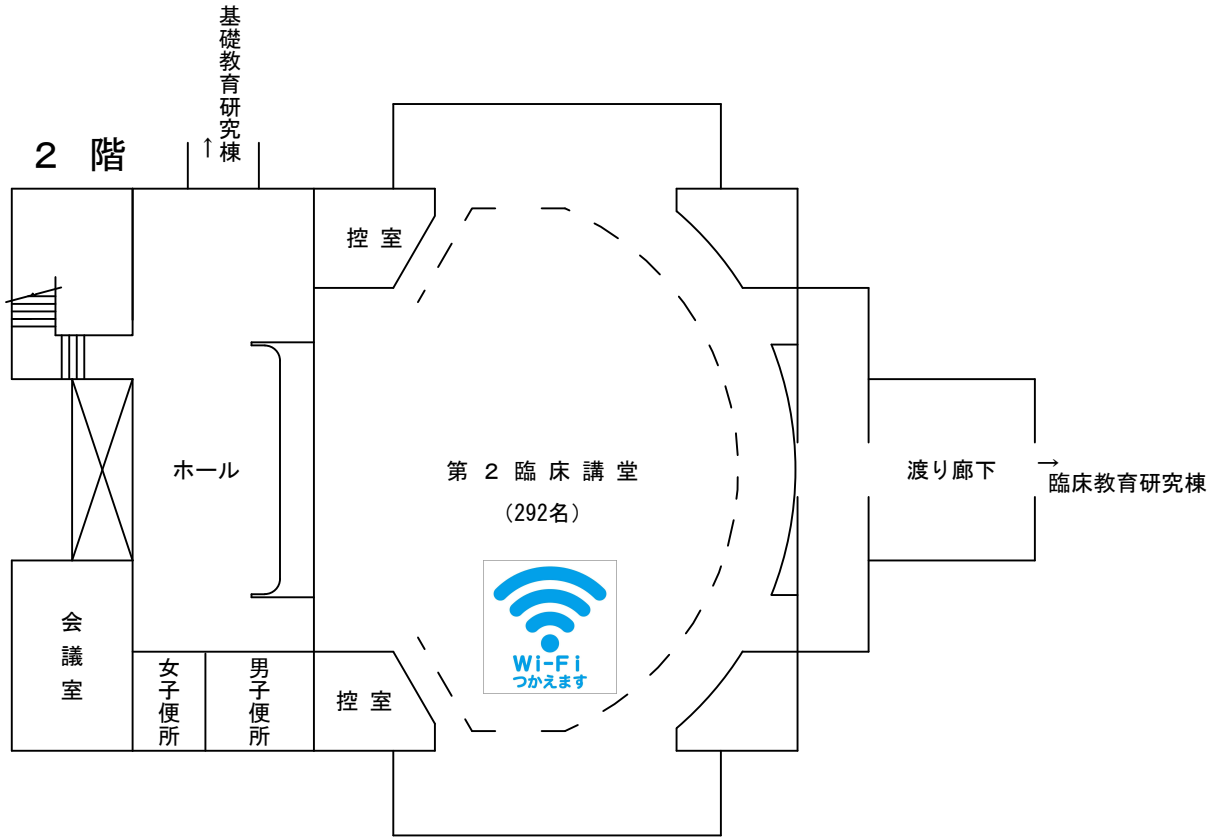

⑦ 記念図書館棟

() 収容人員

5階

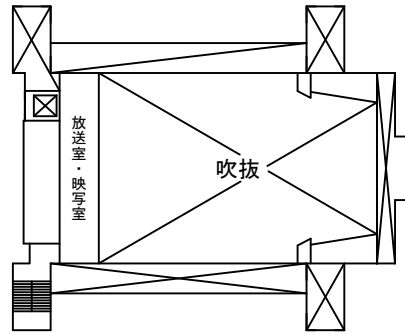

2階

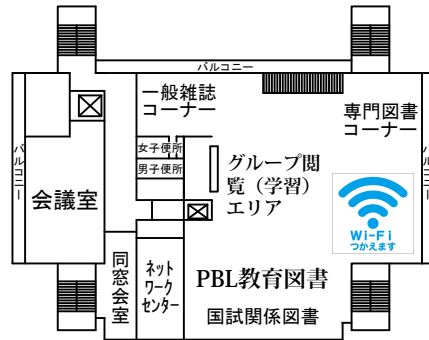

4階



1階

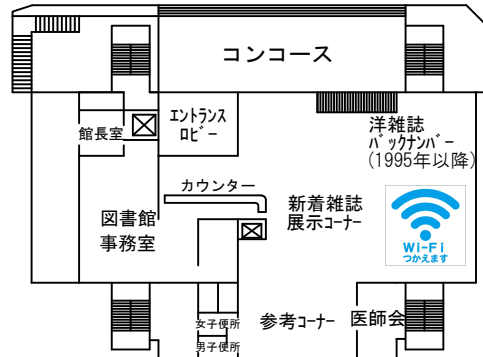

3階

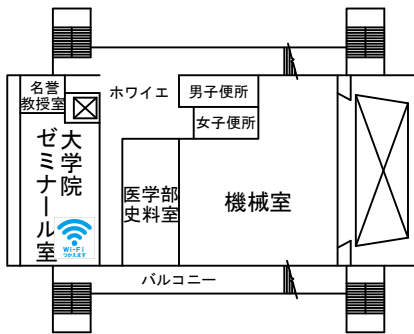

地下中1階

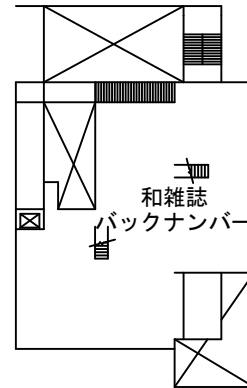

地下1階

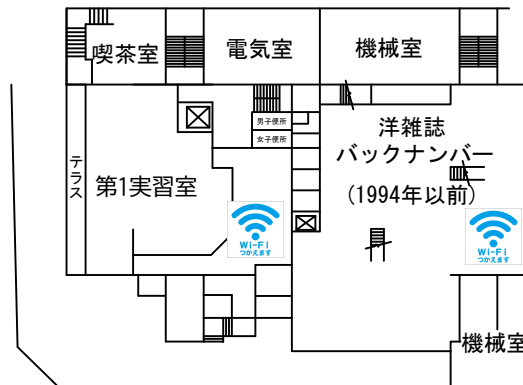

⑧ 体育館

3階

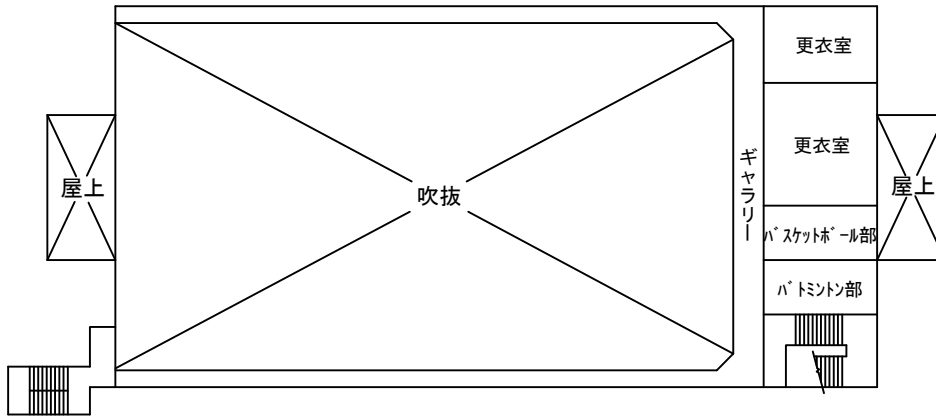

2階



1階

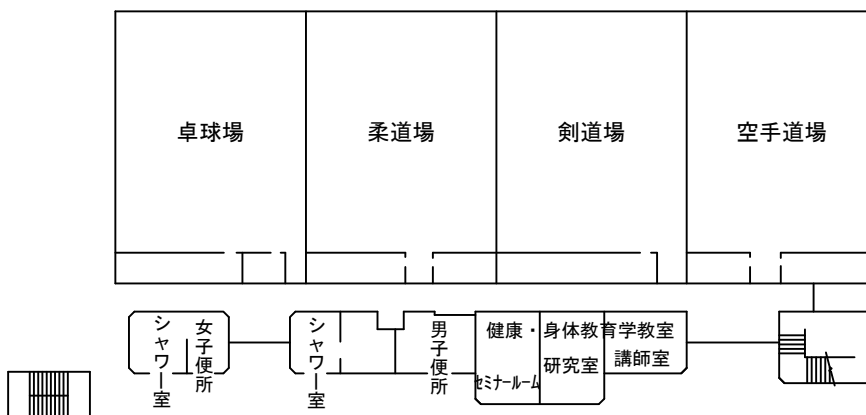

⑨ 社会医学・一般教育棟

4階

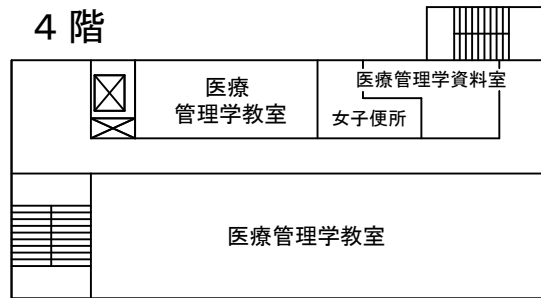

7階

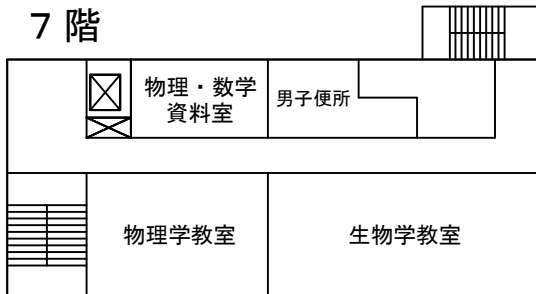

3階

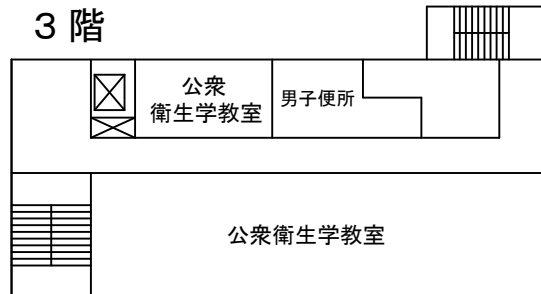

6階

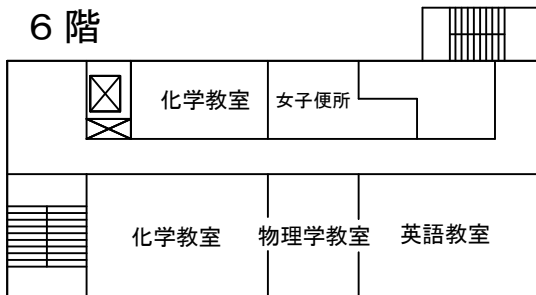

2階

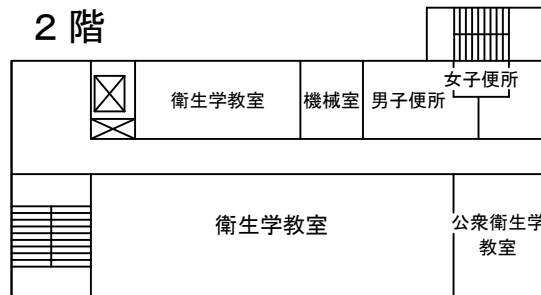

5階

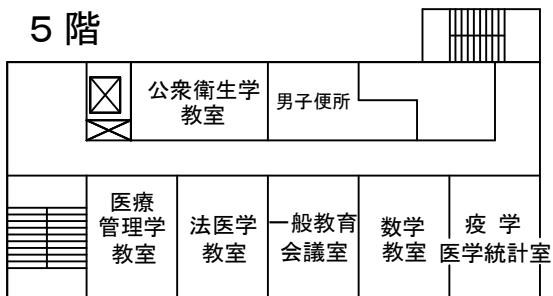

1階

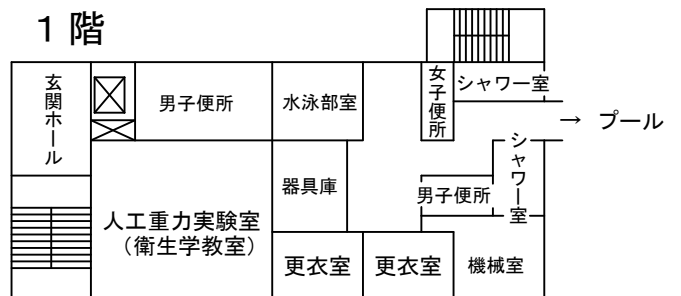

⑩ リサーチセンター

4階



1階

医学研究支援部門（化学分析室）・研究事務課

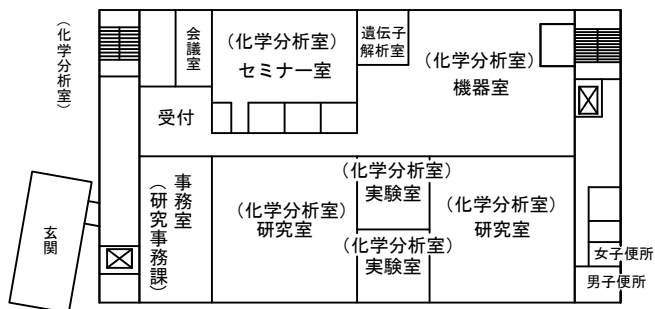

3階

薬理学教室

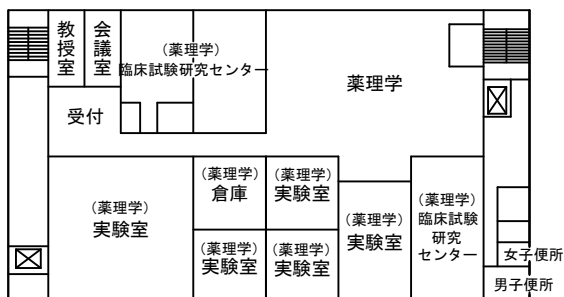

地下1階

細胞再生・移植医学研究室

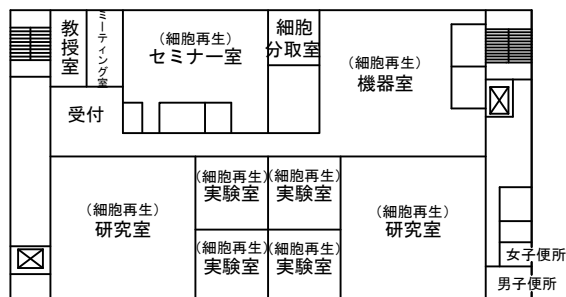

2階

医学研究支援部門（化学分析室）・企画推進室プロジェクト

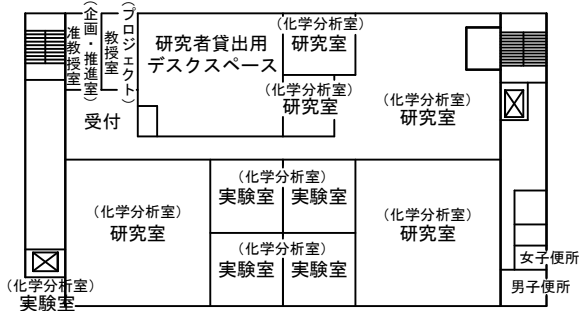

地下2階

