

医学部配置図

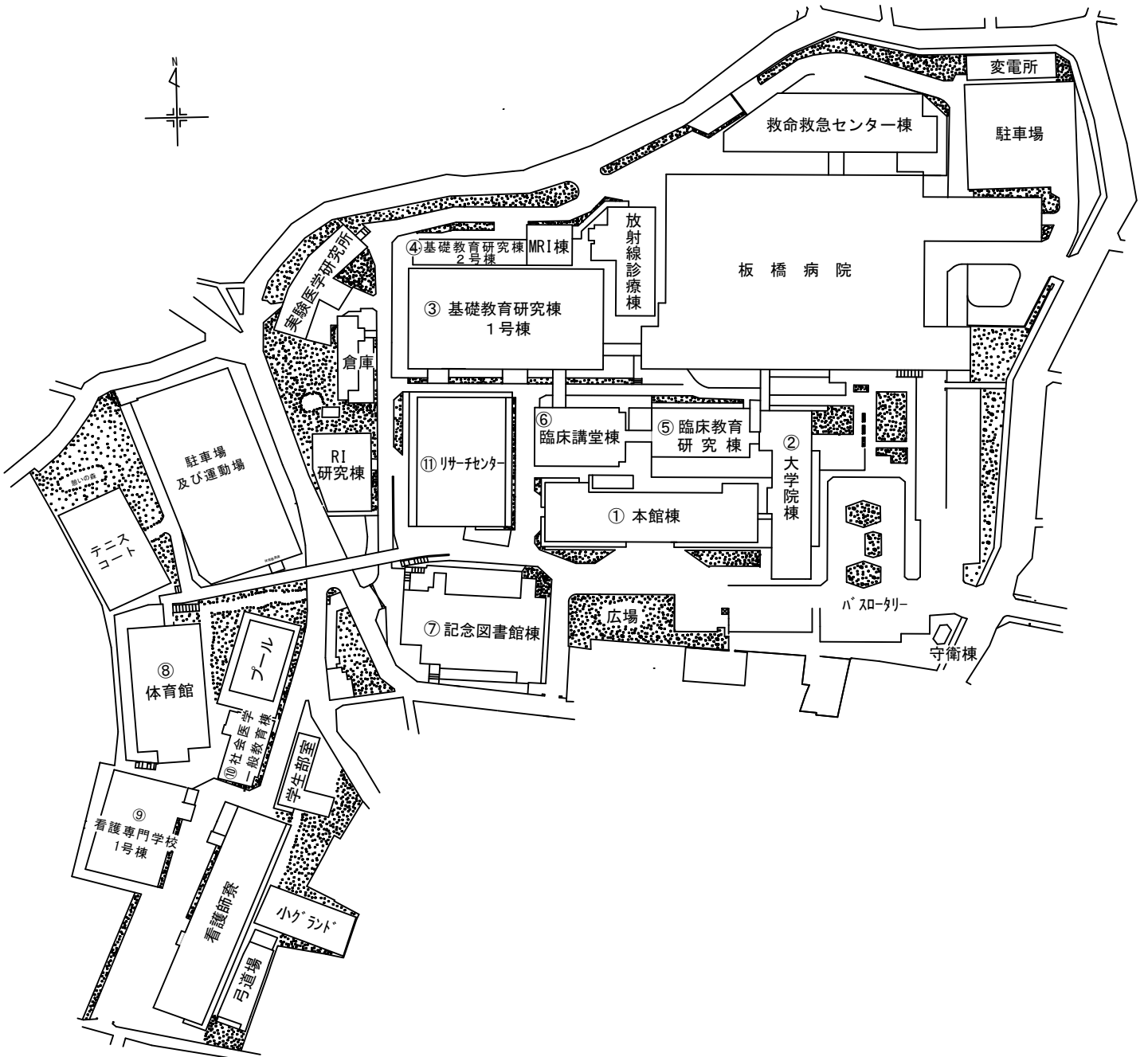

① 本館棟

() 収容人員

4階

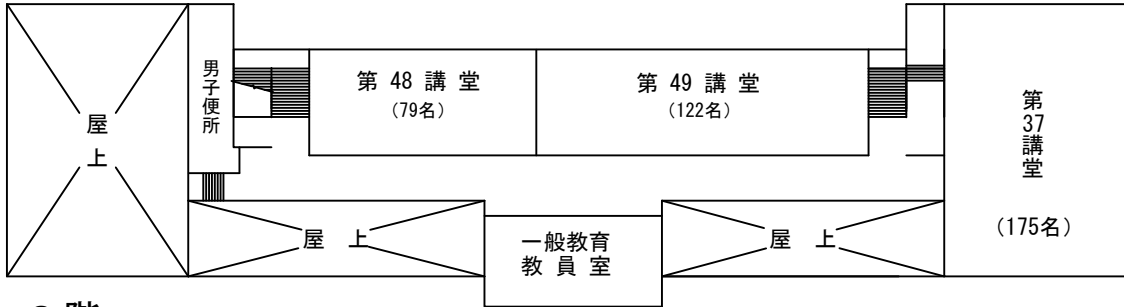

3階

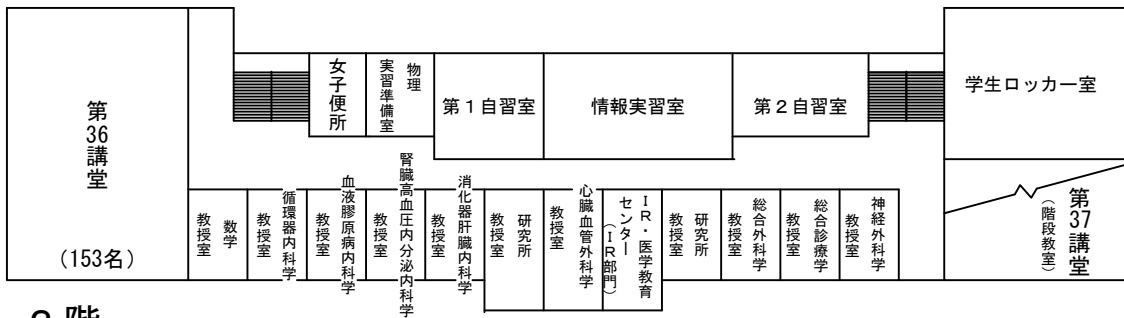

2階

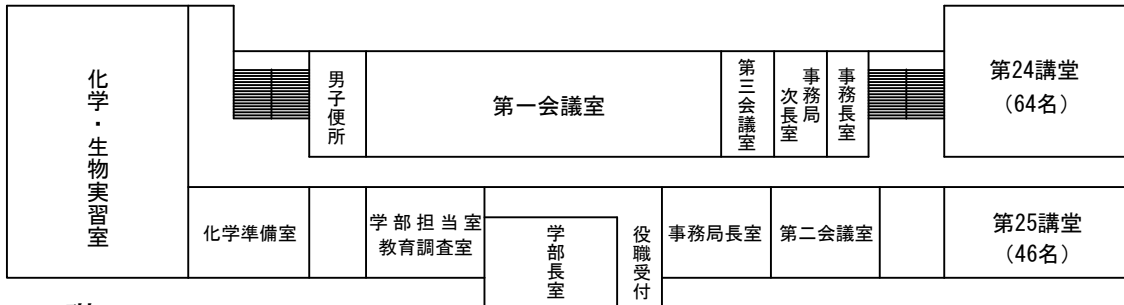

1階

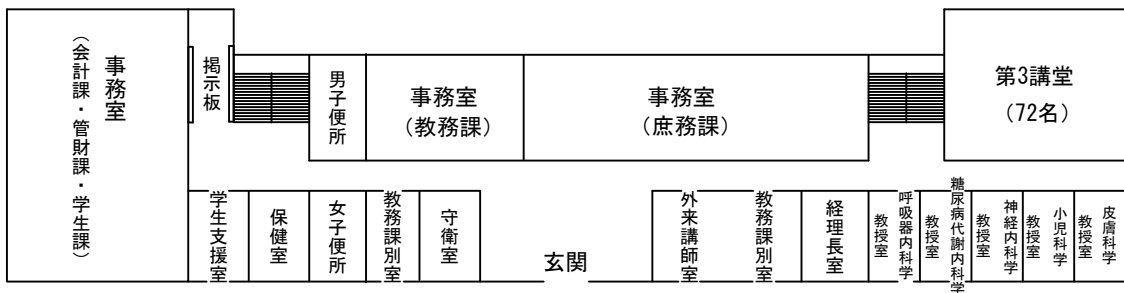

地階

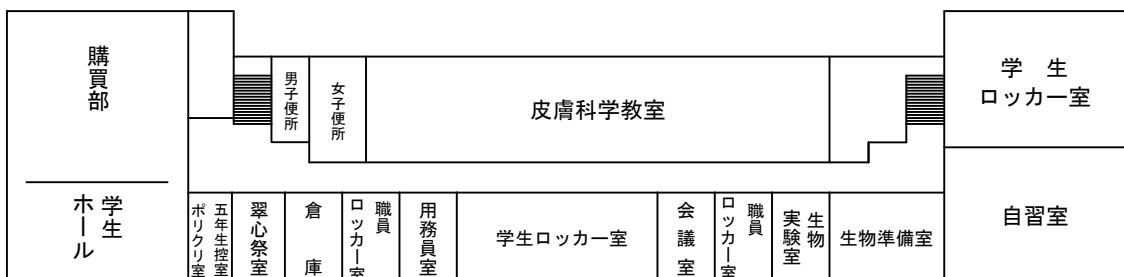

② 大学院棟

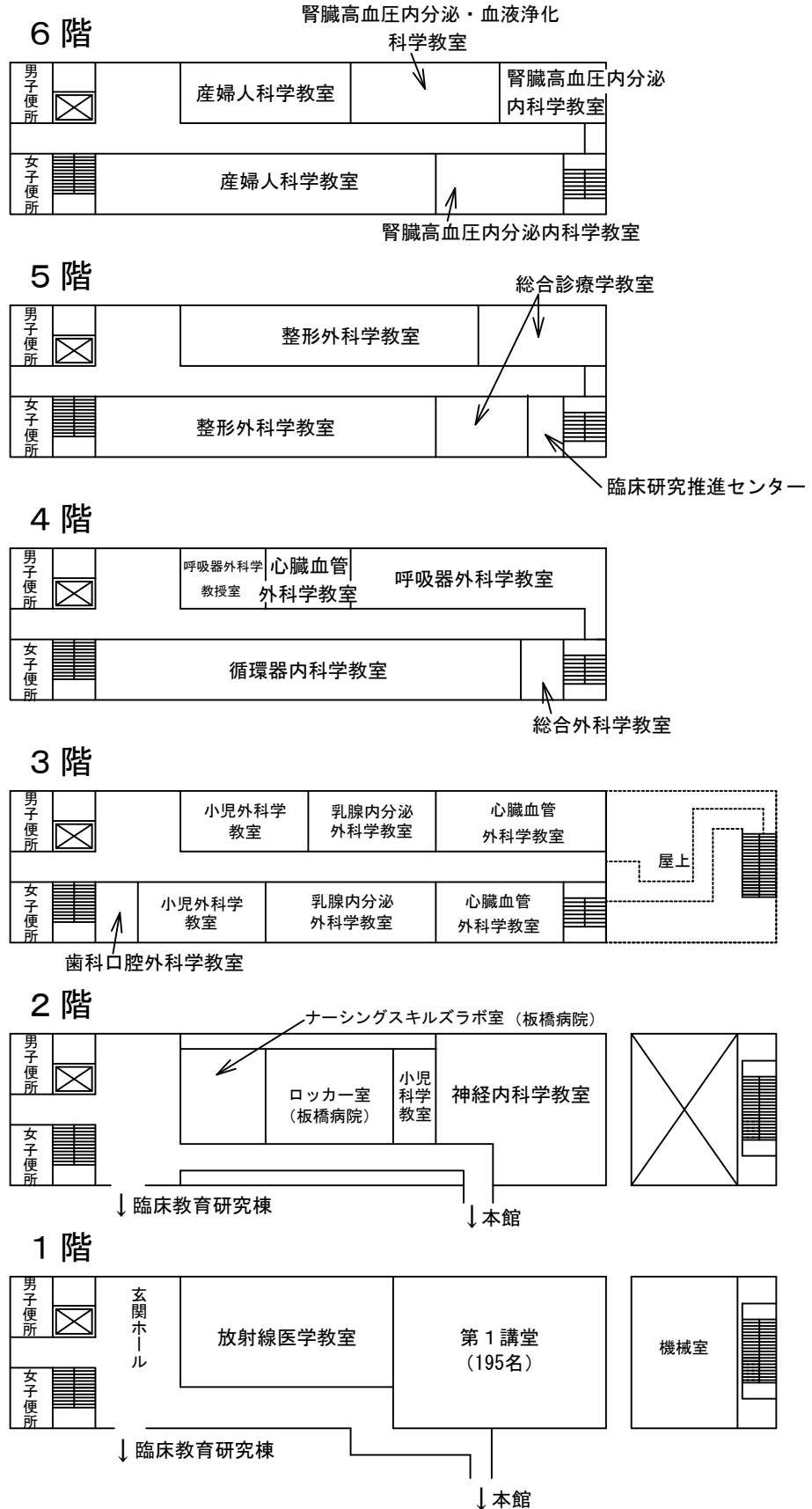

③ 基礎教育研究棟 1号棟

2階

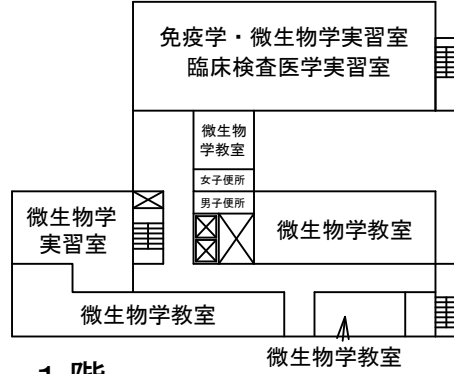

1階

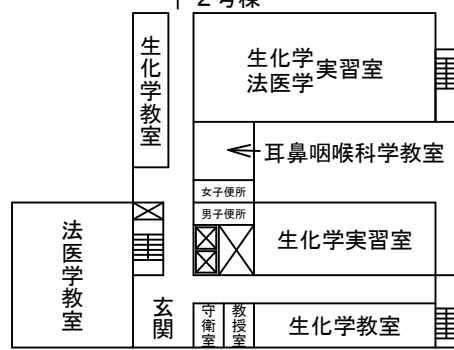

5階

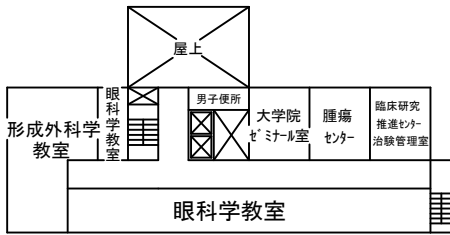

4階

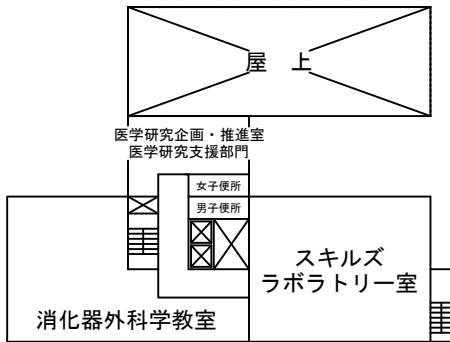

3階

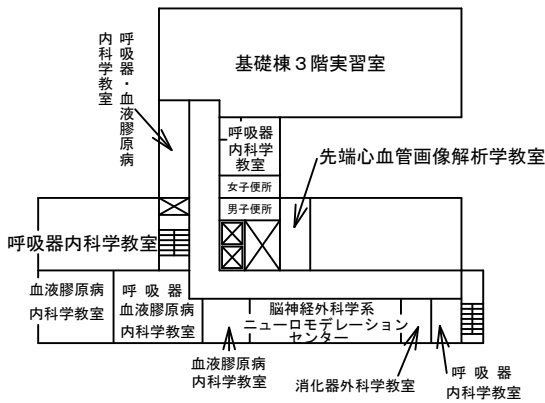

地下1階

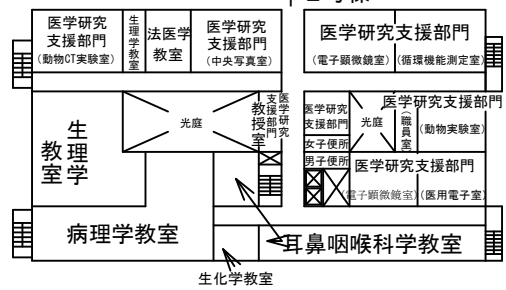

地下2階

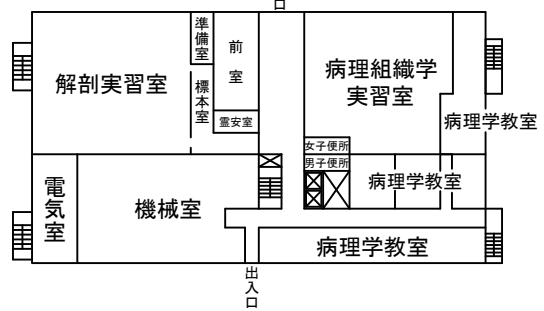

④ 基礎教育研究棟 2号棟

3階

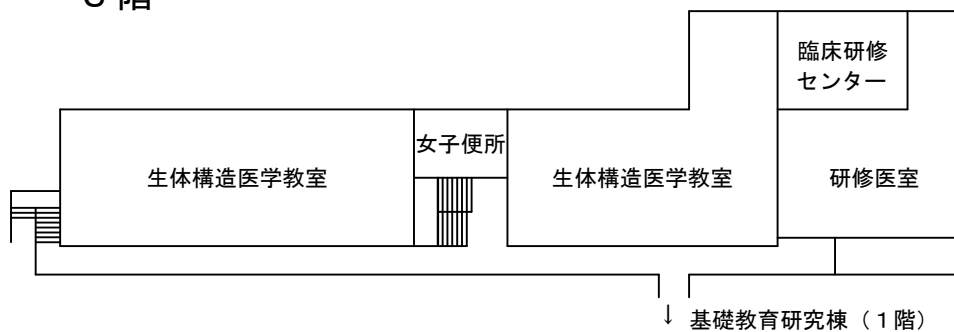

2階

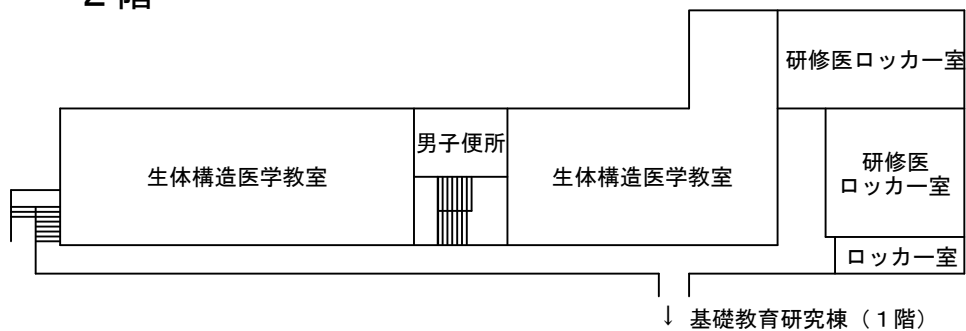

1階

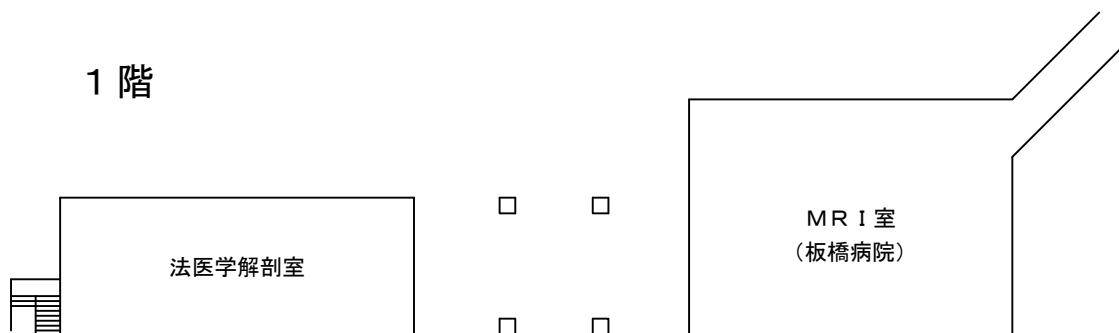

⑤ 臨床教育研究棟

5階

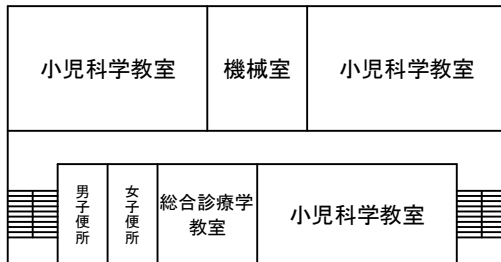

2階

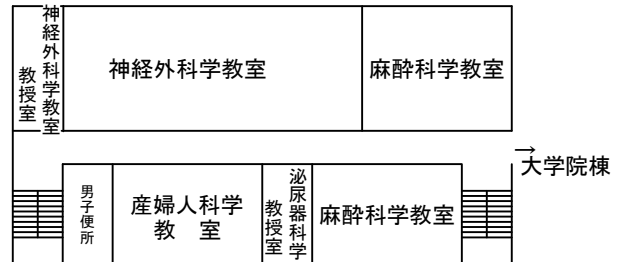

4階

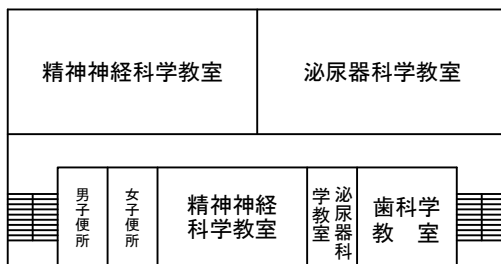

1階

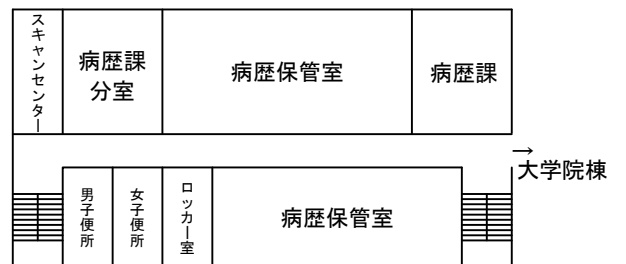

3階

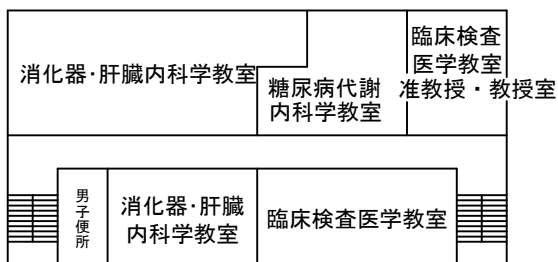

地下1階

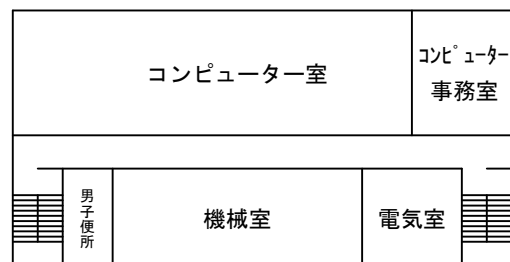

⑥ 臨床講堂棟

() 収容人員

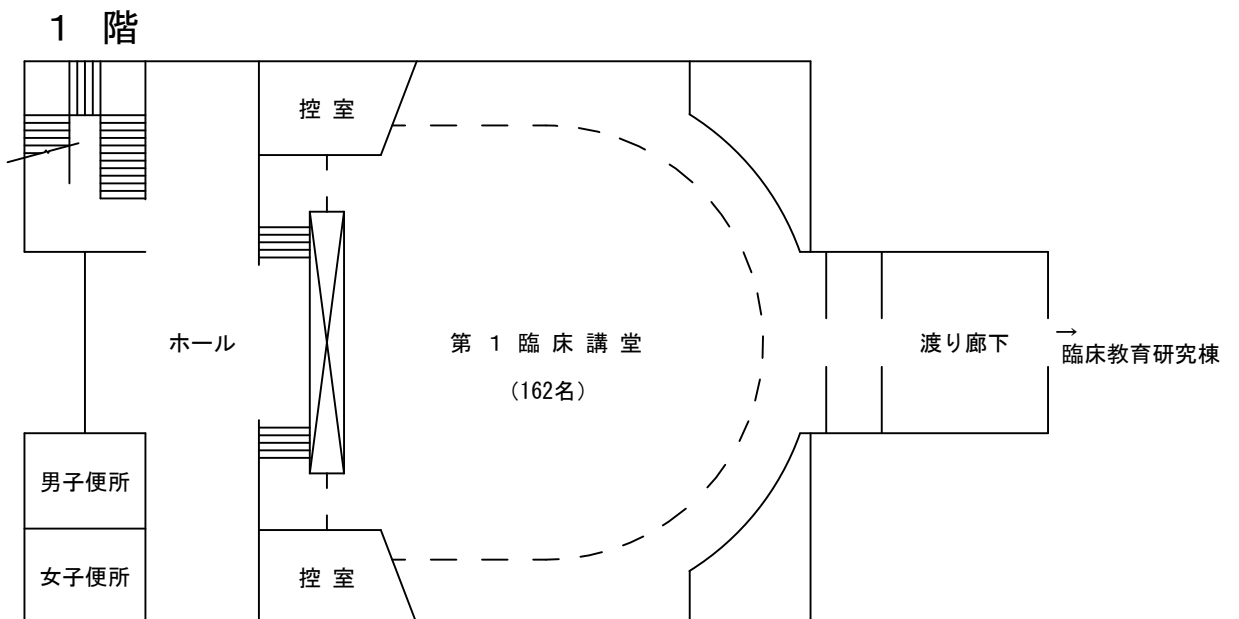
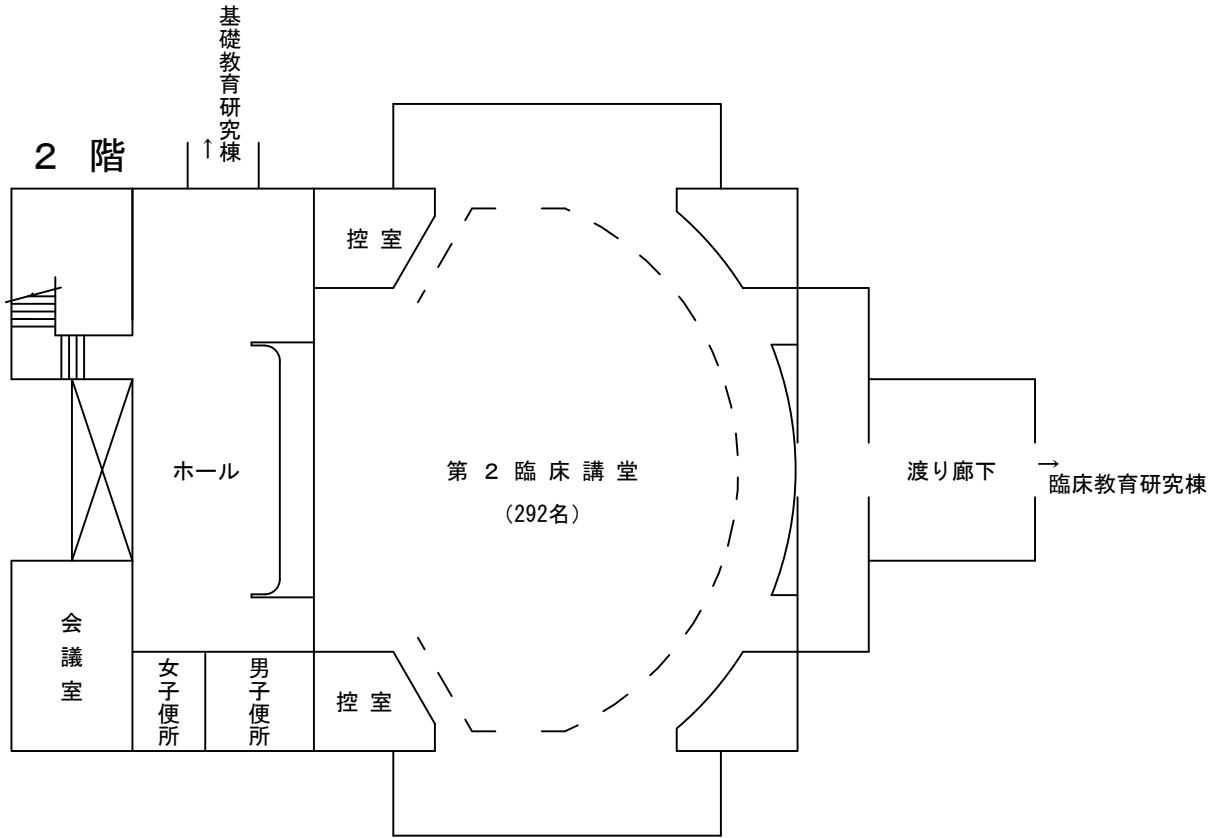

⑦ 記念図書館棟

() 収容人員

5階

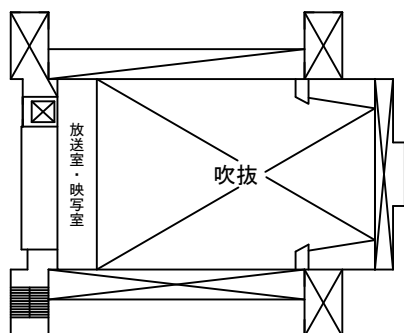

2階

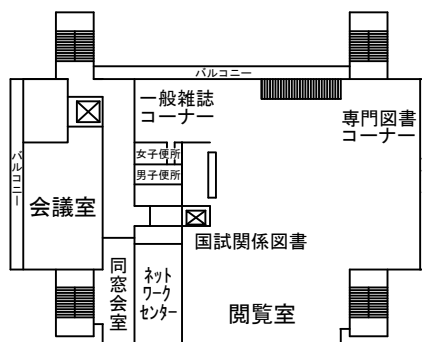

4階

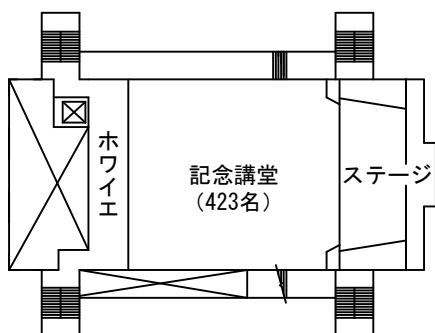

1階

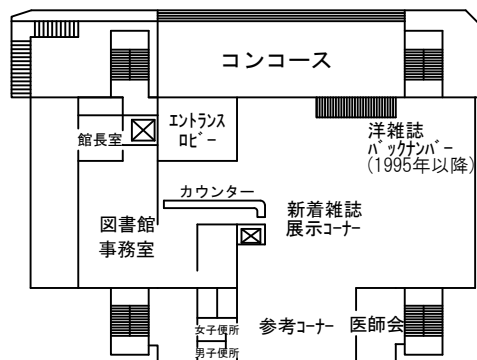

3階

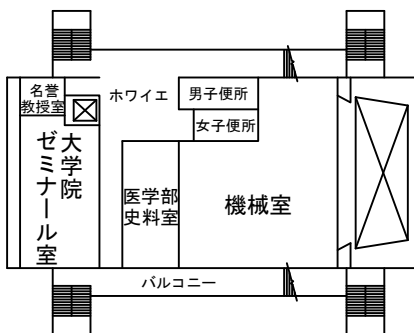

地下中1階

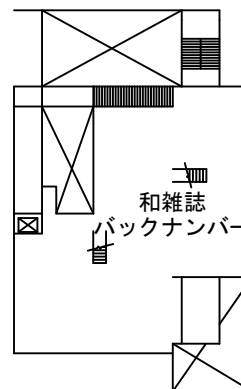

地下1階

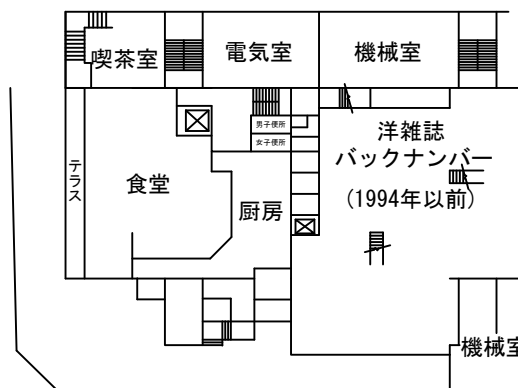

⑧ 体育館

3階

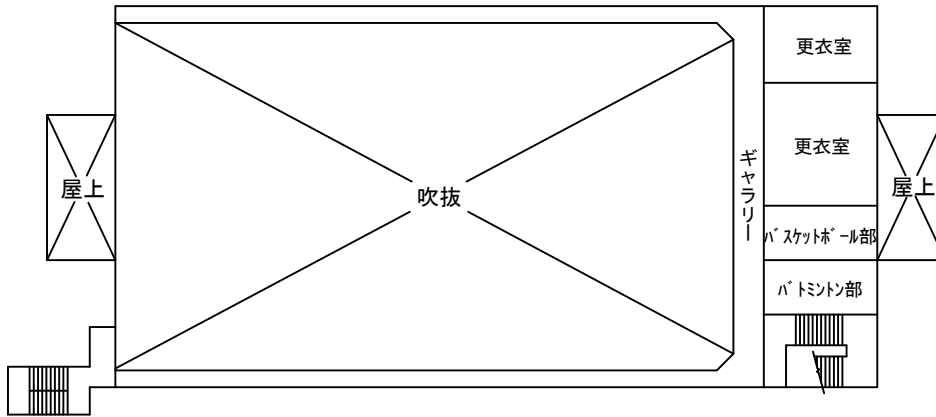

2階



1階

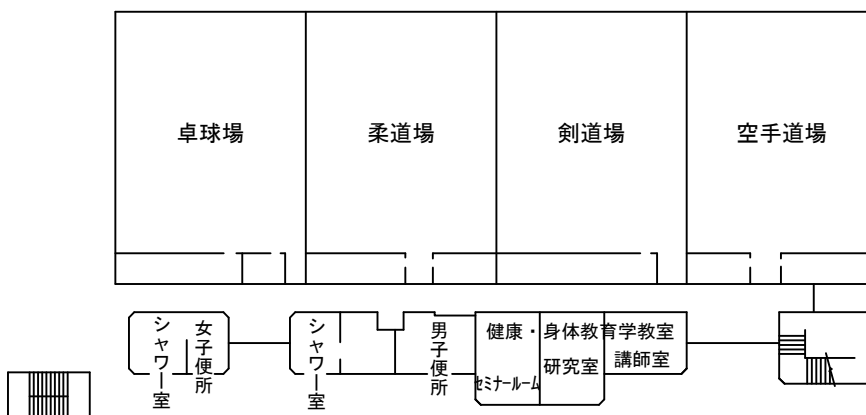

⑨ 看護専門学校 1号棟

7階

SGL教室 701	SGL教室 702	SGL教室 703	SGL教室 704	SGL教室 705	SGL教室 706	SGL教室 707	
	倉庫	SGL教室 712	男子便所	SGL教室 711	SGL教室 710	SGL教室 709	SGL教室 708

6階

SGL教室 601	SGL教室 602	SGL教室 603	SGL教室 604	SGL教室 605	SGL教室 606	SGL教室 607	
	倉庫	SGL教室 612	女子便所	SGL教室 611	SGL教室 610	SGL教室 609	SGL教室 608

5階

会議室A	コンピューター 会議室	モニター室	SGL教室 501	SGL教室 502	SGL教室 503	SGL教室 504	
	倉庫	会議室B	男子便所	SGL教室 508	SGL教室 507	SGL教室 506	SGL教室 505

※ 1階～4階は、看護専門学校が使用しています。

⑩ 社会医学・一般教育棟

4階

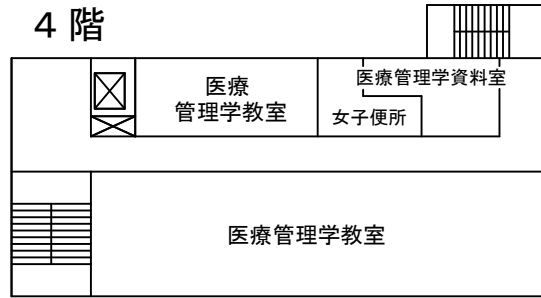

7階

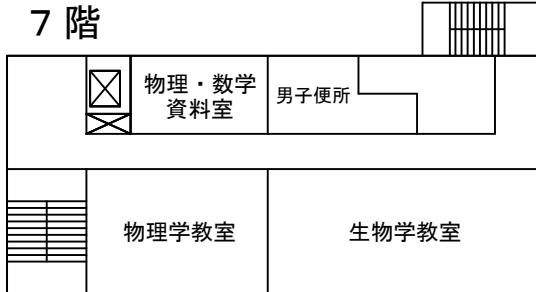

3階

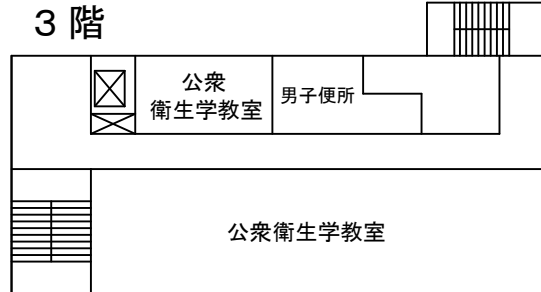

6階

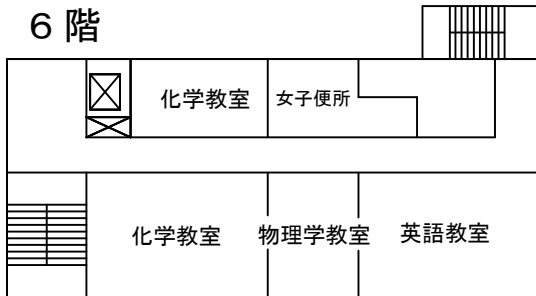

2階

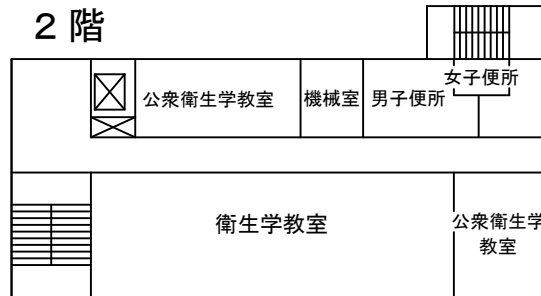

5階

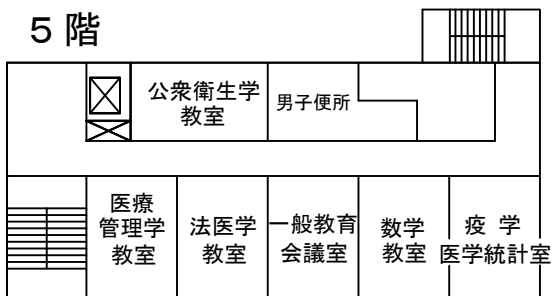

1階

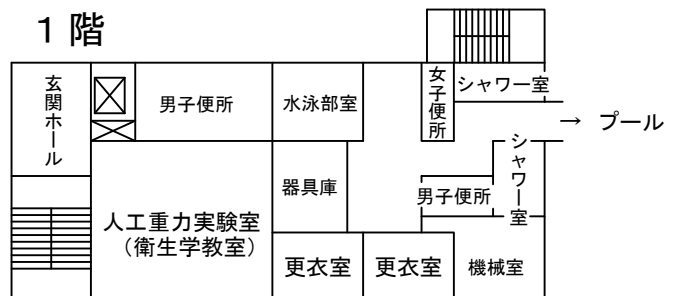

⑪ リサーチセンター

4階

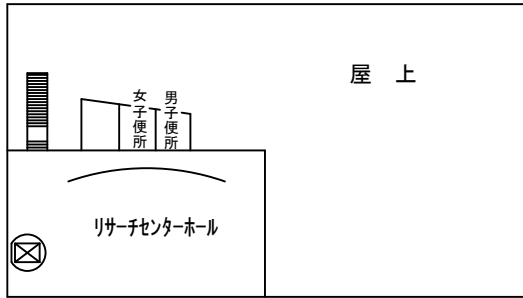

1階

医学研究支援部門（化学分析室）・研究事務課

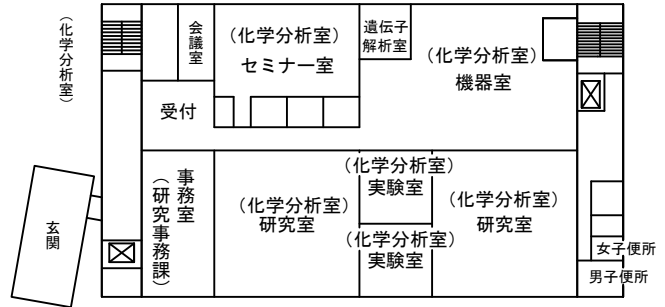

3階

薬理学教室

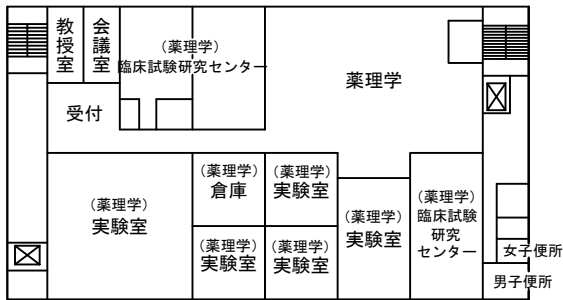

地下1階

細胞再生・移植医学研究室

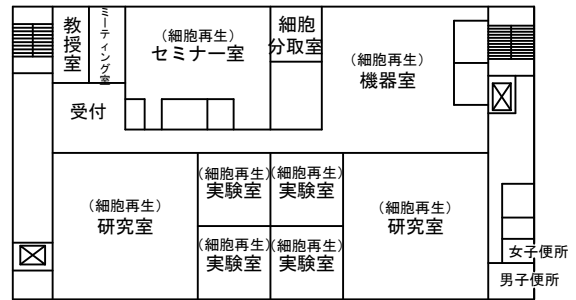

2階

医学研究支援部門（化学分析室）・企画推進室
プロジェクト室

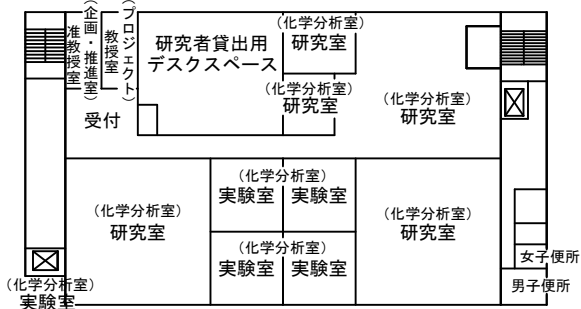

地下2階

